

COMMERCIAL &  
INDUSTRIAL  
HEAT

Part of  
Turnbull & Scott™

FTR | Water-fed Finned Tube Radiator





Water Finned Tube Radiators are stylish and effective, space saving radiators with outstanding performance. Designed for use with a hot water system, their innovative finned tube technology amplifies radiant heating area. Creating a high performance radiator that is not only compact but robust & unbelievably versatile.

Finned Tube Radiators are available from stock in standard lengths of 1000mm and 2000mm, powder coated in black or white.

They can also be made bespoke to order in any RAL colour or stainless steel, in lengths of up to 6000mm.

Sizes range from 25mm NB tube/over fin diameter 65mm – 100mm NB tube/over fin diameter 165mm.

A curved option is also available – curved from a radius of 2m. Can be manufactured for wall or vertical mounting if required.

**For a bespoke design please contact our sales team directly on 01450 372103.**

FINNED TUBE DETAILS						OUTPUTS – WATTS PER METRE USING STILL AIR 20°C AMBIENT												
Tube Nominal Bore mm	Fin Width mm	Diameter over fins mm	Fin Pitch mm	Weight per metre (kg)	Heating Surface m <sup>2</sup> /m	MEAN TEMPERATURE OF WATER °C												
						40	45	50	55	60	65	70	75	80	85	90	95	100
25	16	65	10	3.81	0.789	71	95	120	146	165	197	229	259	292	326	357	392	426
			13	3.46	0.618	66	88	111	135	149	175	203	231	259	288	320	351	380
32	16	73	10	5.06	0.908	81	108	137	167	212	257	298	341	384	429	473	517	561
			13	4.58	0.713	76	101	127	155	202	236	274	310	350	387	428	466	509
32	25.4	92	10	6.41	1.691	114	153	194	136	283	328	373	416	461	505	551	600	648
			14	5.37	1.17	100	134	169	207	223	265	306	347	390	433	479	523	570
40	25.4	98	10	7.18	1.785	126	168	213	260	312	358	405	452	501	548	599	650	702
			14	6.04	1.24	109	146	185	226	246	289	336	381	425	472	519	567	618
50	25.4	108	10	9.18	2.05	146	195	248	303	360	413	468	522	577	631	691	748	808
			14	7.87	1.426	126	168	213	260	288	337	388	442	496	549	605	662	721
			19	7.22	1.118	112	149	189	231	247	289	336	380	426	473	519	569	620
65	25.4	124	10	11.48	2.361	161	215	273	333	429	484	548	610	676	740	808	877	948
			14	9.88	1.654	143	191	242	295	336	394	454	513	577	637	702	769	834
			19	9.08	1.301	131	175	221	269	288	336	388	440	492	547	602	658	719
80	25.4	137	10	14.13	2.617	177	235	298	363	466	531	601	671	740	813	884	960	1032
			14	12.29	1.837	158	210	266	324	377	440	505	570	636	704	774	846	920
			19	11.35	1.447	146	193	244	298	324	378	433	490	548	606	668	730	793

Dimensions: FTR80/25/10

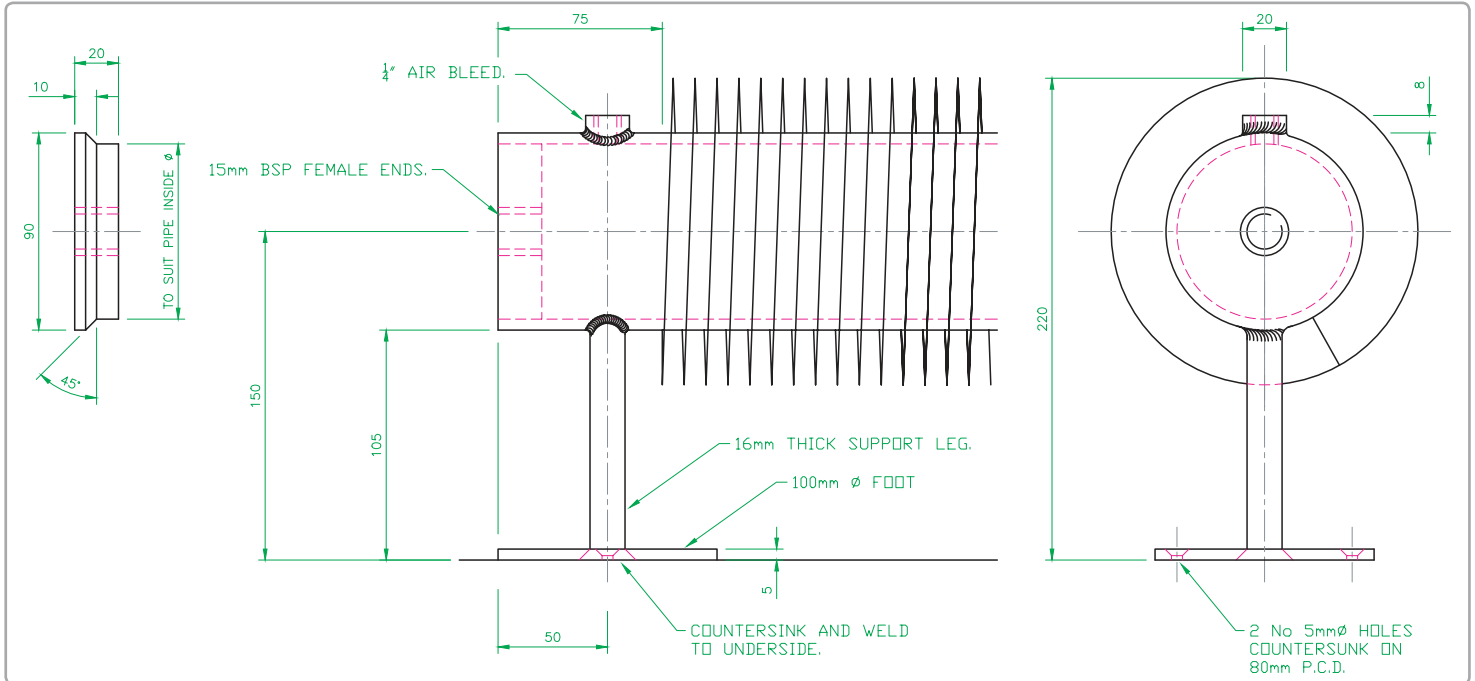

## Finned tube radiators Operating and maintenance instructions

On start up from cold the heating medium should be admitted slowly to the exchanger to avoid thermal shock and air vents, where appropriate, should be in operation.

Upon reaching working temperature/pressure a check should be made for any leaks at pipework connections and in the case of steam units the operation of the steam trapping equipment should be checked.

Periodic cleaning of the finned tube radiator should be carried out by means of air, water or simple brushing where appropriate.

Frequency of cleaning can only be determined in practice since it will depend entirely on the type and amount of foreign matter in the air stream. Care should be taken during the cleaning process to avoid damaging the fins.